

SLIP ON FLANŞ 300 LB



ASME B 16.5 - 2013
BS 3293



E.M.P.
www.emp.com.tr
www.empflans.com

SLIP ON FLANGE CLASS 300



ASME B 16.5 - 2013
BS 3293

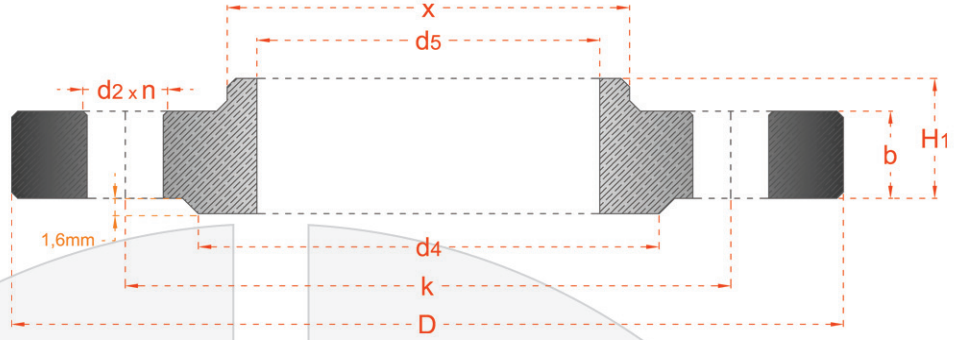

| ASME B16.5-2013 | | | | | | | | | | | AĞIRLIK WEIGHT |
|-----------------|--------|--------|-------|--------|----------------------|--------|------|-------|-------|-------|-------------------|
| DN | NPS | D | b | d4 | DELİKLER - DRILLINGS | | | X | d5 | H1 | kg |
| | | | | | n | k | d2 | | | | |
| 15 | 1/2" | 95 | 14.3 | 34.9 | 4 | 66.7 | 15.8 | 38 | 22.2 | 21 | 1.2 |
| 20 | 3/4" | 115 | 15.9 | 42.9 | 4 | 82.6 | 19.0 | 48 | 27.7 | 24 | 1.3 |
| 25 | 1" | 125 | 17.5 | 50.8 | 4 | 88.9 | 19.0 | 54 | 34.5 | 25 | 1.4 |
| 32 | 1 1/4" | 135 | 19.1 | 63.5 | 4 | 98.4 | 19.0 | 64 | 43.2 | 25 | 1.8 |
| 40 | 1 1/2" | 155 | 20.7 | 73.0 | 4 | 114.3 | 22.2 | 70 | 49.5 | 29 | 2.5 |
| 50 | 2" | 165 | 22.3 | 92.1 | 8 | 127.0 | 19.0 | 84 | 61.9 | 32 | 3 |
| 65 | 2 1/2" | 190 | 25.4 | 104.8 | 8 | 149.2 | 22.2 | 100 | 74.6 | 37 | 4.5 |
| 80 | 3" | 210 | 28.6 | 127.0 | 8 | 168.3 | 22.2 | 117 | 90.7 | 41 | 6 |
| | 3 1/2" | 230 | 30.2 | 139.7 | 8 | 184.2 | 22.2 | 133 | 103.4 | 43 | 7.5 |
| 100 | 4" | 255 | 31.8 | 157.2 | 8 | 200.0 | 22.2 | 146 | 116.1 | 46 | 10.1 |
| 125 | 5" | 280 | 35.0 | 185.7 | 8 | 235.0 | 22.2 | 178 | 143.8 | 49 | 12.5 |
| 150 | 6" | 320 | 36.6 | 215.9 | 12 | 269.9 | 22.2 | 206 | 170.7 | 51 | 17.5 |
| 200 | 8" | 380 | 41.3 | 269.9 | 12 | 330.2 | 25.4 | 260 | 221.5 | 60 | 26 |
| 250 | 10" | 445 | 47.7 | 323.8 | 16 | 387.4 | 28.5 | 321 | 276.2 | 65 | 38 |
| 300 | 12" | 520 | 50.8 | 381.0 | 16 | 450.8 | 31.8 | 375 | 327.0 | 71 | 52 |
| 350 | 14" | 585 | 54.0 | 412.8 | 20 | 514.4 | 31.8 | 425 | 359.2 | 75 | 74 |
| 400 | 16" | 650 | 57.2 | 469.9 | 20 | 571.5 | 35.0 | 483 | 410.5 | 81 | 100 |
| 450 | 18" | 710 | 60.4 | 533.4 | 24 | 628.6 | 35.0 | 533 | 461.8 | 87 | 127 |
| 500 | 20" | 775 | 63.5 | 584.2 | 24 | 685.8 | 35.0 | 587 | 513.1 | 94 | 147 |
| 600 | 24" | 915 | 69.9 | 692.2 | 24 | 812.8 | 41.1 | 702 | 616.0 | 105 | 208 |
| BS 3293 | | | | | | | | | | | |
| 650 | 26" | 971.5 | 79.4 | 749.3 | 28 | 876.3 | 44.4 | 720.7 | 666.7 | 184.1 | 255 |
| 700 | 28" | 1035 | 85.7 | 800.1 | 28 | 939.8 | 44.4 | 774.7 | 717.5 | 196.8 | 321 |
| 750 | 30" | 1092.2 | 92.1 | 857.2 | 28 | 996.9 | 47.8 | 827.1 | 768.3 | 209.5 | 362 |
| 800 | 32" | 1149.3 | 98.4 | 914.4 | 28 | 1054.1 | 50.8 | 881.1 | 819.1 | 222.2 | 398 |
| 850 | 34" | 1206.5 | 101.6 | 965.2 | 28 | 1104.9 | 50.8 | 936.6 | 869.9 | 231.8 | 480 |
| 900 | 36" | 1270 | 104.8 | 1022.3 | 32 | 1168.4 | 53.8 | 990.6 | 920.7 | 241.3 | 540 |

Ölçüler mm olarak verilmiştir.
Çelik ve paslanmaz üretilebilir.

Dimensions are in mm.
Steel and stainless steel can be produce.

36" ÜZERİ FİRMAMIZ TARAFINDAN ÜRETİLEBİLMEKTEDİR BİLGİ ALINIZ.